

E 605,500 E 606,000 E 606,500 E 607,000 E 607,500 E 608,000 E 608,500

N 281,000
N 280,500
N 280,000
N 279,500

LEGEND

- Roads
- Drives (over 200ft)
- Railroads
- Buildings
- Endwalls and Culverts
- Catch Basin
- Manhole
- Rivers and Streams
- Fences (cross country)
- Walls, retaining, stone
- Trees
- Swamp and Marsh
- Lakes and Ponds
- Contours
- Depression
- Spot elevation
- Control, vertical
- horizontal
- Bridges
- Towers



Michael J. Gorman, Jr.
MAYOR

REVISION	DATE	BY

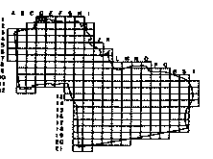

SHEET INDEX

JAMES P. PURCELL ASSOC.
Glastonbury, Ct.

SHEET NO.

D 1

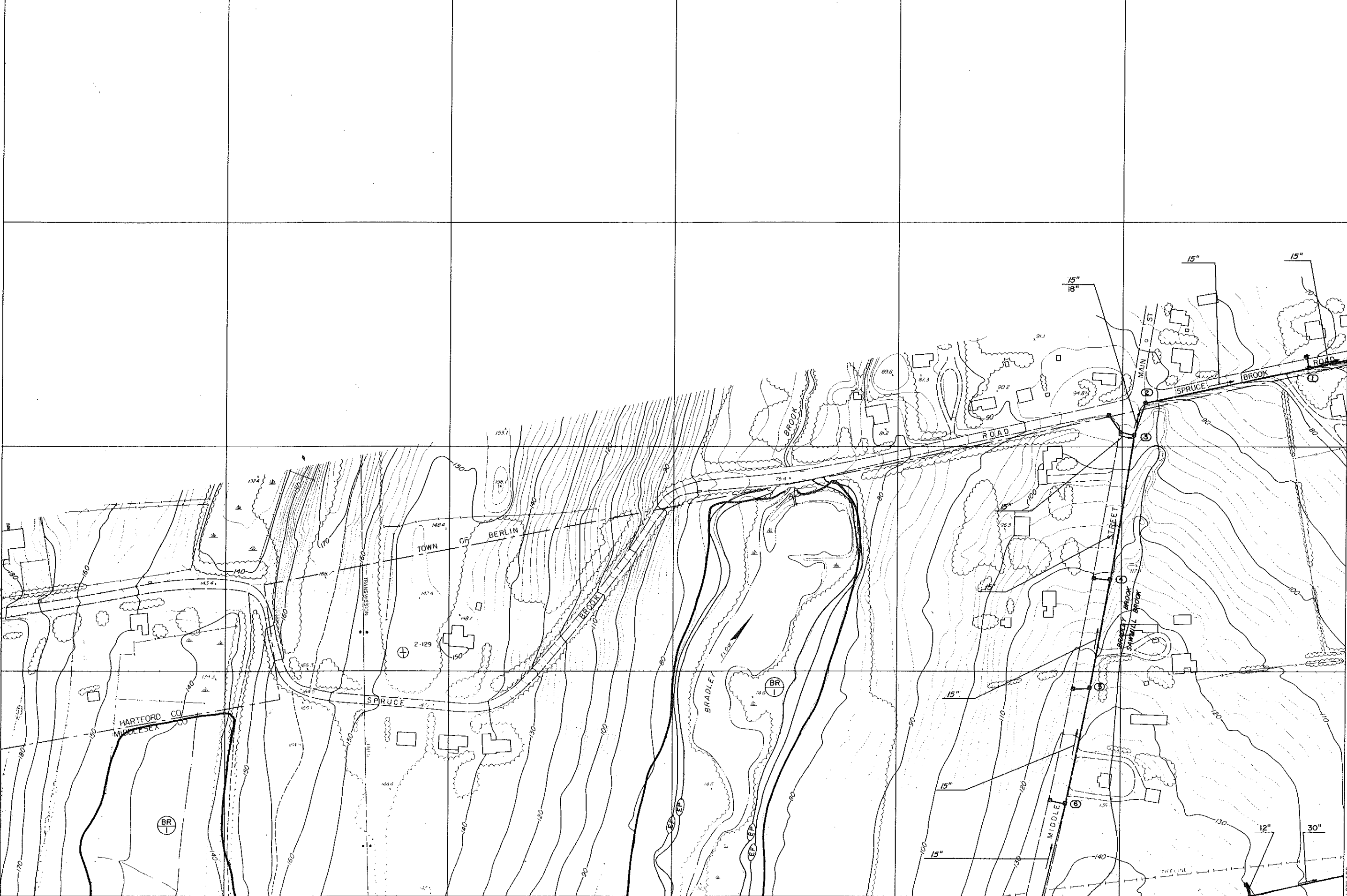

MATCH TO INSERT SHEET C-2

MAP COMPILED USING PHOTODIAGRAMMETRIC METHODS BY



DATE OF PHOTOGRAPHY APRIL 17, 1980

THIS MAP COMPLES WITH OR EXCEEDS NATIONAL MAP ACCURACY STANDARDS:

DASHED CONTOURS ARE SHOWN IN AREAS OBSCURED BY DENSE VEGETATION. VERTICAL ACCURACY MAY BE REDUCED.

DRAINAGE AND WETLANDS INFORMATION PREPARED BY PURCELL ASSOC. 1981

TOPOGRAPHIC MAP OF THE

CITY OF MIDDLETOWN, CONNECTICUT

WITH DRAINAGE SYSTEMS AND INLAND WETLANDS SUPERIMPOSED



CONTOUR INTERVAL 2' SCALE 1" = 100'

500 FOOT GRID BASED ON CONNECTICUT RECTANGULAR GRID SYSTEM NATIONAL GEODETIC VERTICAL DATUM OF 1929